

Non-Ferrous Melting Systems

SX-7
SX-8

Pillar non-ferrous melting systems are designed to melt and pour a variety of alloys.

Drop Coil Furnace (DCF)

The Drop Coil Furnace is designed for use with free standing crucible melting of non-ferrous metals in conductive crucibles. Features include a high efficiency coil, free standing fabricated steel furnace base, confinement area, refractory pedestal for crucible support, single hand operated lever, pneumatic cylinder and flow control valves.

Hand Furnace (HF)

Hand Furnace complete with refractory fiber reinforced shell, top and bottom, shank plates and induction coil with terminations for use with water cooled leads.



MK-25 Power Supply



Hand Furnace,
Manual Pour Operation

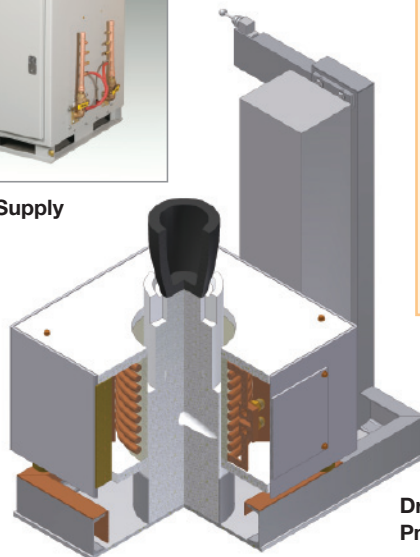

Drop Coil Furnace,
Pneumatic Operation

Melting System Specifications:

Power Supply: Pillar MK-25
Power Range: 30 kW - 50 kW

Drop Coil Furnace System Includes:

- MK-25, 30 kW Power Supply
- Drop Coil Furnace, 30 lb, Pneumatic Operation
- Lead Adaptors
- Water Cooled Power Leads up to 15 ft (4.5 m)

Hand Furnace System Includes:

- MK-25, 50 kW Power Supply
- Hand Furnace, 50 lb Manual Pour Operation
- Lead Adaptors
- Water Cooled Power Leads up to 15 ft (4.5 m)

Options:

- Water Cooling and Recirculating System to water
- Water Recirculating System – Chiller

SX System #	MK-25 Power Supply Rating	Frequency Rating	Furnace / Size (Drop Coil or Hand)	Cooling System Type	Melt Time Steel at 3,000°F*	Melt Time Iron at 2,700°F*	Melt Time Brass at 2,150°F*	Melt Time Gold at 2,200°F*	Melt Time Silver at 1,900°F*
7	30 kW	10,000 Hz	30 lb (14 Kg) DCF	Water to Water	—	—	—	34 minutes	60 minutes
8	50 kW	10,000 Hz	50 lb (23 Kg) HF	Chiller	18 minutes	15 minutes	17 minutes	—	—

* Based on nominal furnace size for a second heat utilizing a lid or blanket and a rammed lining with a 10% heel, when lining is hot, charge is dense and bus lead runs proper.

Non-Ferrous Melting Systems

SX-7
SX-8

Drop Coil Furnace (DCF) & Hand Furnace (HF) — MK-25 Power Supply



MK-25 Power Supply

- IGBT transistor modules
- Electrical isolation
- Single main control board
- NEC & NFPA wiring codes
- Inlet and outlet pressure gauges with pressure differential switch
- Internal heat station
- Water inlet and outlet on top of cabinet
- Safety door interlock switch
- CE or ETL certification available
- Forklift slots under cabinet
- Precut power exit and entry locations
- Current transformer for sensing the coil current
- Control board with a choice of three feedback inputs
- Front panel diagnostics
- 95% conversion efficiency

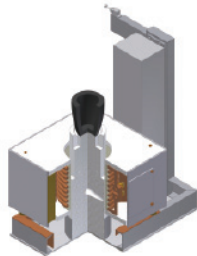

Drop Coil Furnace (DCF)

- Single post retract mechanism for clear access to crucible
- High efficiency induction coil with cast liner
- Smooth pneumatically operated lift & lower operation
- Single hand lever or foot switch actuation
- Flow control valves
- Free Standing structural steel base and frame
- Confinement area
- Precast refractory crucible base slotted for pour shank
- Designed for Pour Shank Clearances
- High Strength Ceramic and refractory box construction



Hand Furnace (HF)

- High efficiency induction coil with cast liner
- Refractory fiber reinforced shell, top and bottom
- Two man pour shank yoke attachments designed for use with a customer provided two man pour shank
- Hand furnace support table with heat resistant table top and structural frame. Table dimensions: 16"W x 18"H x 18"D

Ancillary Equipment



Water Cooling and Recirculating System – WCRS-1-5

- Stainless steel storage tank
- Latched stainless steel cover
- Sight and temperature gauge
- Bronze pump with open drip proof motor
- Manual pump starter and controls
- Stainless steel plate type water-to-water heat exchanger
- All non-ferrous piping
- Unitized base



Water Recirculating System – Model 5000

- Air-cooled portable chillers
- Local or remote condensor
- Non-ferrous construction
- Safety disconnect
- Up to 45°F ambient temperature with 65°F leaving fluid temperature
- Stainless steel pump
- Nonferrous center circuit construction
- Built-in diagnostics
- R-410A

USA Headquarters

21905 Gateway Road
Brookfield, WI 53045
Phone: +1 262-317-5300
Fax: 262-317-5353

CHINA

No. 533 Yuan Zhong Road
Nanhui Industrial Zone
Shanghai, China 201399
(86) 21-68009546
(86) 21-68009542 (FAX)

ENGLAND

2 Dorset Road,
Saltley Business Park
Saltley, Birmingham B8 1 BG
(44) 121 322 8000
(44) 121 322 8080 (FAX)

GERMANY

Ersheimer Str. 87
69434 Hirschhorn, Germany
49 62 72 92 17 500
49 62 72 92 17 587 (FAX)

JAPAN

1-6-35 Shinsuna
N-Building, 7th Floor
Koto-Ku, Tokyo, 136-0075 Japan
(81) 33647 7661
(81) 33647 7662 (FAX)

KOREA, Seoul

Room #201, Dae-Ryuk Bldg, 103-9
Guro-Dong, Guro-Ku, Seoul Korea
(82) 2 837 2290
(82) 2 837 2292 (FAX)

MEXICO

Avenue Manantiales No. 11
Esq. Acueducto
Parque Industrial Bernardo Quintana
El Marquez, Queretaro
C P 76246 Mexico
(011) 52 442 221 5415
(011) 52 442 221 5090 (FAX)

THAILAND

Suite 4, 36th Floor
All Season Place
87/2 Wireless Road
Lumpini Phatumwan
Bangkok 10330 Thailand
(66) 02 625 3111
(66) 02 625 3045